

FAMED LODZ S.A.

Excellence through experience,
for over 75 years.

IGNIS 160CAM/TV/160C

Operating Light



IGNIS 160 – lightweight, compact design with a circular shape. The casing is made of powder coated aluminium with the safety glass on the bottom part. The construction guarantees easiness of use and cleaning.

By applying a small amount of external elements the dome is well protected against water and dust.

IGNIS 160 is equipped with two independent handles. The sterile handle allows focusing of the light spot. The non-sterile handle surrounds the dome in more than 75% of its circumference, which provides independent access and makes the positioning very easy.

The unique solution applied in **IGNIS 160** are two control panels located on the dome opposite each other, which provides a good access independently of the position of the operator. Additionally, these panels allow to control not only the parameters of the light but also the parameters of the image.

IGNIS 160 is as standard equipped with HD camera which can be operated using two control panels placed on the dome. The central light panel guarantees excellent penetration of light, whenever it is required. Additionally, it provides a homogeneous spot of light in the operation field, irrespective of the distance of the dome.

IGNIS 160 is equipped with the independent function of endoscope light, located on the upper part of the dome. As a result of the research and consultation with the doctors we used a green color light, which ensures the best representation of the red color, so important during endoscope procedures.

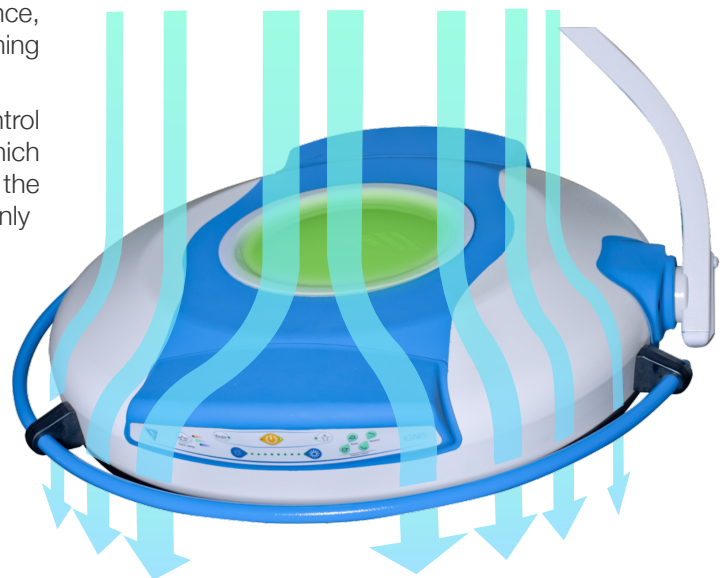

Technical drawing

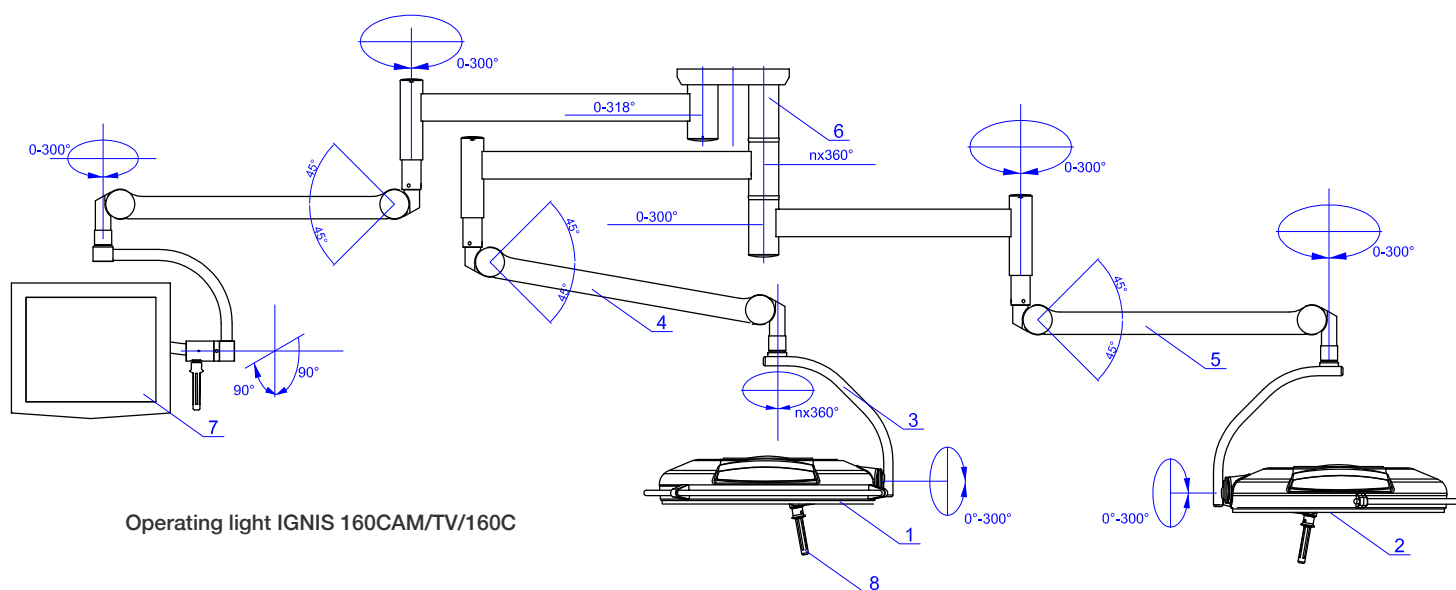

Parameters

Lighthead	IGNIS 160 main	IGNIS 160 satellite
Equipped with HD camera	yes	no
Supply voltage	24V DC	
Light intensity at a distance of 1 m (Ec)	160 000 lx	
Adjustable light intensity	25 ÷ 100%	
Colour rendering index Ra	96	
Colour temperature	4000 / 4400 / 4800 K	
Operating field diameter d10	280 mm	
Light spot diameter d50	140 mm	
Adjustable diameter of the operating field	yes	
Temperature increase near surgeon's head	< 1°C	
Depth of illumination L1+L2	140 cm	
Power consumption for the lighthead	50 W	
Insulation class	I	
Lifetime of LED diodes	50 000 h	
Protection degree provided by lighthead enclosure	IP 54	

Available options:



Our products meet the requirements
of the European Directive
MDD 93/42/EEC
and European standards
**IEC 60601-1-2011, IEC
60601-1-2-2007**



FABRYKA APARATURY ELEKTROMEDYCZNEJ
FAMED Łódź S.A.
ul. Ciasna 21 a
93-531 Łódź, POLAND



www.famed.pl



info@famed.pl



Jarosław **Majchrzak**
+48 784 012 501



j.majchrzak@famed.pl

Agnieszka **Leśniewicz**
+48 601 276 583
a.lesniewicz@famed.pl

Leszek **Kaniewski**
+48 662 066 064
l.kaniewski@famed.pl